

# 1<sup>st</sup> Newsletter

## COPA DEL MÓN



## LA SEU D'URGELL

1 - 3  
d'agost

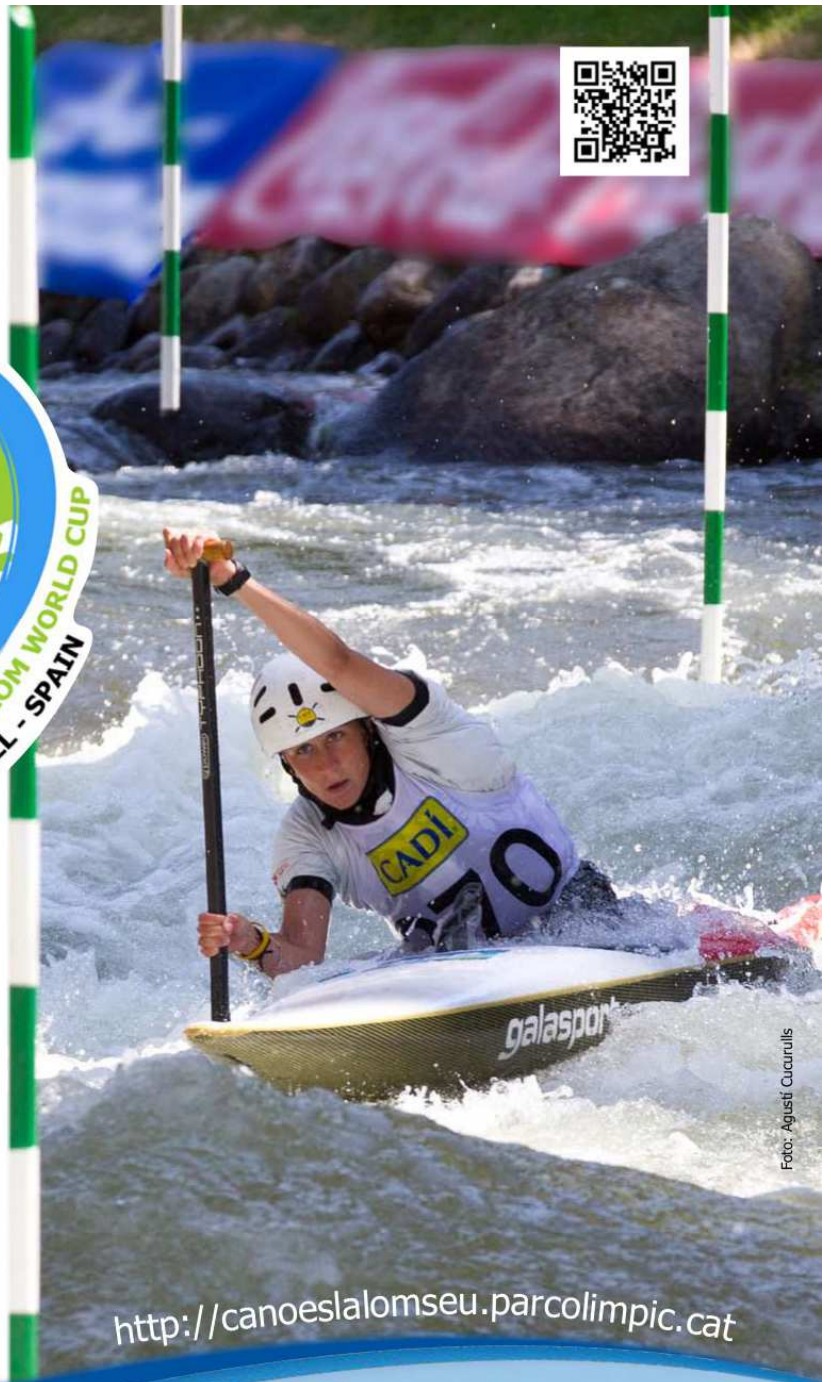

<http://canoeslalomseu.parcolimpic.cat>

Foto: Agustí Cucurull



## 1<sup>st</sup> NEWSLETTER (March 2014)

TABLE OF CONTENTS	Page
RFEP Invitation	3
Facts about La Seu d'Urgell	4
Parc Olímpic del Segre venue	5
How to get to La Seu d'Urgell	6
Airports to get to La Seu d'Urgell	7
Maps from Barcelona Airport to La Seu d'Urgell	8
Other close training course	8
Venue Maps	9
Organizing Committee	10
Provisional Competition Programme	11
Entries and key dates for team leaders	12
Accreditation and participation fee	13
Accommodations, press and media information	14
Information from the organizer	15
Contacts	16



Dear President,  
Dear Secretary General,

### **Welcome for the 4<sup>th</sup> ICF Canoe Slalom World Cup event**

The La Seu d'Urgell Organizing Committee, together with the partners in London, Ljubljana, Prague and Augsburg, have a new challenge to improve the events in a homologated format under the guidance of ICF. The issue is to support the sport in a fair and sophisticated competition, and promote the values of canoe slalom. In addition there is intention to diffuse the tourist interest of this Pyrenean area, marked by nature and history.

We hope that all team members and visitors could feel our friendly hospitality anywhere on their stay in the city.

Our organization is possible for our volunteers dedicated people, which help the event the best that they can. Thanks all of them.

Thanks to Institutional partners and sponsors that permit to continue this service to the sport.

On behalf of them and our organizing committee I wish you all a nice stay in La Seu d'Urgell.

A handwritten signature in blue ink, consisting of a stylized, scribbled shape that resembles a globe or a sphere with a horizontal line through it.

Juan José Román Mangas  
President of the Royal Spanish Canoe Federation  
President of Organizing Committee



## Facts about La Seu d'Urgell



The historic city of La Seu d'Urgell, on the Catalan Pyrenees, has a tradition of over 40 years organizing white water canoe competition events. The Olympic games of Barcelona 1992 was a landmark on this support of canoe slalom.

Later those memorable days that permitted slalom to be accepted on the Olympic programme, several World Cup events and the World Championships 1999 and 2009 endorse the facilities on Parc Olímpic del Segre and the organizing team. This year 2014 is the 50<sup>th</sup> anniversary of the canoe club CADÍ.

The **2014 Canoe Slalom World Cup, to be held from 1<sup>st</sup> to 3<sup>th</sup> of August**, is a new opportunity to give service to the slalom canoe family.

The challenge aims to improve technology on sport competitions, presence on media (especially TV), and worldwide promotion of canoe slalom through the participation over 40 national teams, and attract tourism in La Seu d'Urgell. The history on the old town, the mountain valley around Cadí-Moixeró Natural Park, and the local dedication to sport should be known.

In addition this occasion will keep active and financially healthy the Olympic facility of Park del Segre.

The World Cup are possible thanks to the support of institutions and sponsorships. On behalf of the organizing Committee we thank their help.

We trust on the contribution of the participant teams and we are ready to work for a fair competition and a happy stay in our country.

On behalf of ICF, RFEP, FCP and the Organizing Committee, **welcome to the 2014 Canoe Slalom World Cup.**



## Parc Olímpic del Segre venue

The Parc Olímpic del Segre is constructed in a branch of the Segre river, which was re-channelled after the damage caused by the exceptional flood of 1982. The slalom course's specific features are as follows:

- Length: 300 m
- Drop: 6,5 m
- Flow: 12 m<sup>3</sup>/s
- Course features: concrete bottom, banks and obstacles of natural boulders
- Spectators capacity: 5.000 people

The Competition Course is accompanied by a beginners course which is 130 m long with a drop of 1,5 m. The designed flow ranges from 3 to 10 m<sup>3</sup>/s.

The design of the artificial canals includes a system of complementary canals and mechanical conveyor belts which enable canoeists to return to their starting point without having to leave their boats. The dynamic conception of the whole facilities leads to intensive use all year round and separation of paddlers according to their levels of skill and ability.

The drop in the Slalom course is created naturally via channels that branch from the Segre river, with a very gentle slope. The feeder canal, 185 in length, and mainly the flat water canal, 650 m in length and 20 m in width, are set aside for training in flat water canoeing and the necessary practice that sport lovers require in waters with a steady current.



## How to get to La Seu d'Urgell



La Seu d'Urgell is placed at 10 km of Andorra and 180 km of Barcelona

GPS: Latitude 42,22N / Longitude 1,28E

### HOW TO GET HERE:

#### **BARCELONA AIRPORT Novatel (Barcelona Airport - Andorra)**

It's necessary to book the ticket. <http://www.andorrabybus.com>

Tel. (+376) 803789

E-mail: [novatel@andorrabybus.com](mailto:novatel@andorrabybus.com)

Timetables: Airport – Andorra: 10:30h – 13:00h – 15:00h – 17:00h – 20:00h – 22:00h  
Andorra – Airport: 5h – 8h – 10h – 12h30 – 17h

#### **TOULOUSE AIRPORT Novatel ( Gare Matabiau – Andorra)**

It's necessary to book the ticket. <http://www.andorrabybus.com>

Tel. (+376) 803789

E-mail: [novatel@andorrabybus.com](mailto:novatel@andorrabybus.com)

Timetables: Gare Matabiau – Andorra: 10:30h 15:00h – 19 30h  
Andorra – Gare Matabiau: 5:00h – 10:00h 15:00h

#### **GIRONA AIRPORT Novatel (Girona Airport – Andorra- Girona Airport)**

It's necessary to book the ticket. <http://www.andorrabybus.com>

Tel. (+376) 803789

E-mail: [novatel@andorrabybus.com](mailto:novatel@andorrabybus.com)

Timetables: Girona Bus Station – Andorra: 09h45 – 19h45  
Andorra – Girona Airport: 5h00 – 14h00

#### **BARCELONA (CITY) Barcelona Bus Station (Estació del Nord) – La Seu d'Urgell**

Alsina Graells <http://www.alsa.es>

Tel. (+34) 902 422242

Timetables: Barcelona – La Seu d'Urgell: 6h30 – 7h30- 15h -19h  
La Seu d'Urgell – Barcelona: 6h15 - 06h30 - 16h30

#### **LLEIDA Lleida (Bus Station) – La Seu d'Urgell**

Alsina Graells <http://www.alsa.es>

Tel. (+34) 902 422242

Timetables Lleida – La Seu d'Urgell: 8h45 -16h15 -19h30  
La Seu d'Urgell – Lleida: 6h15 - 15h45 - 16h30



## Airports to get to La Seu d'Urgell

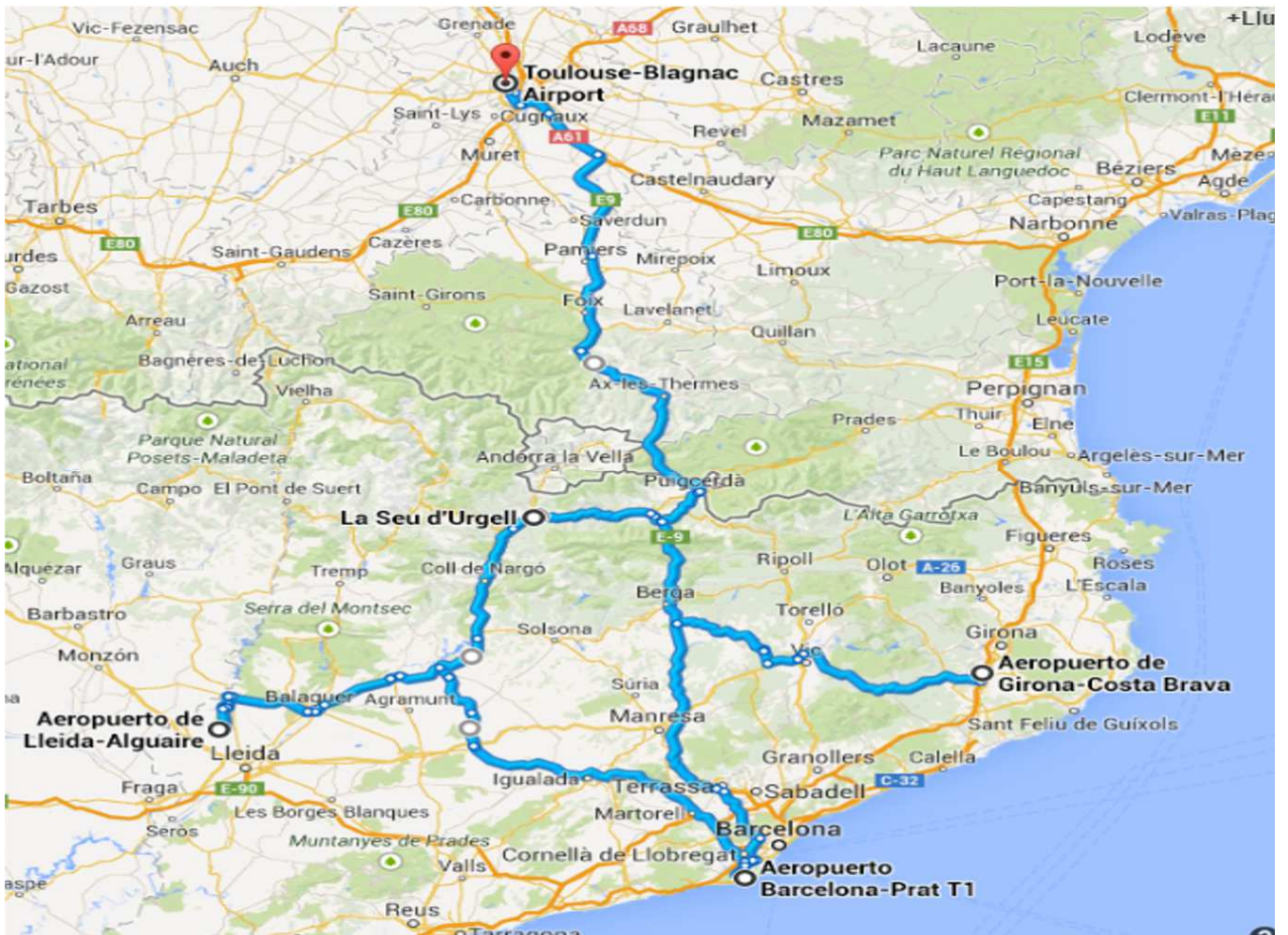

Distance from La Seu d'Urgell to:

- ✓ **Barcelona airport (180 km)**
- ✓ **Alguaire-Lleida airport (135 km)**
- ✓ **Girona-Barcelona airport (198 km)**
- ✓ **Toulouse (FRA) airport (223 km)**



## Maps from Barcelona airport to La Seu

### By Cadí Tunnel (tollroad)



### By Igualada - Cervera - Ponts (toll-free)



## Other close training course: ARFA and PONTS

### ARFA - 4 kms (Segre River)



### PONTS - 60 kms ( Segre River)





# Venue MAPS

1. OFFICIALS AREAS
2. COMPETITION VENUE
3. TEAMS
4. MEDICAL FACILITIES
5. MEDIA AREAS
6. OFFICES AREA
7. VIP AREAS
8. SPECIAL HOSTING AREAS

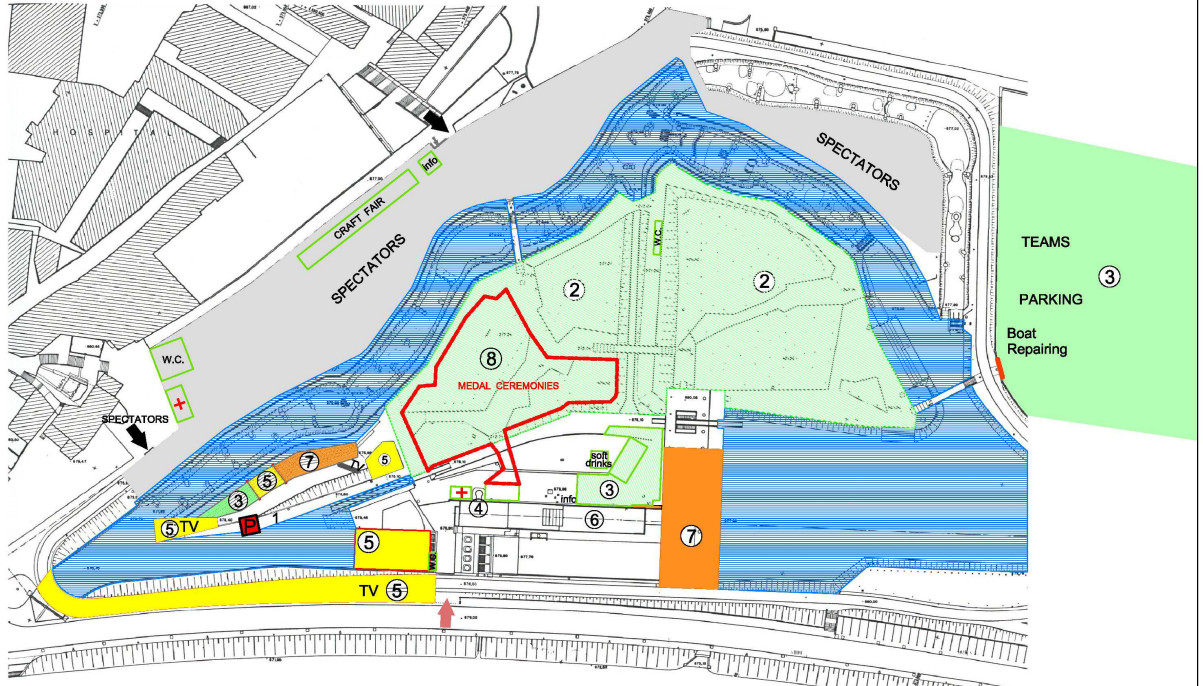

## CANOE SLALOM WORLD CUP LA SEU D'URGELL 1 - 3 AUGUST 2014

- PUNTO DE CONCENTRACION
- SALIDA DE EMERGENCIA
- EVACUACION

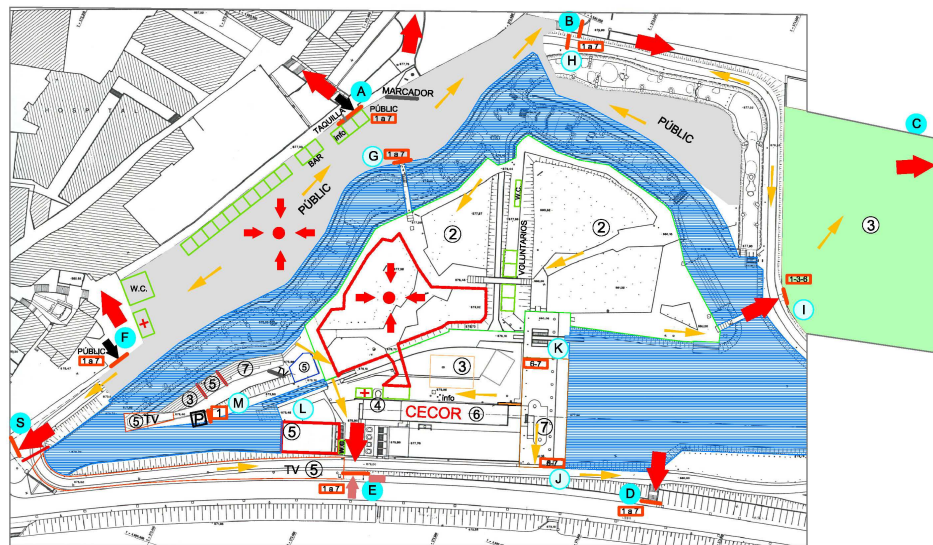

		EL PROYECTO: RAMON GANYET SOLÉ Enginyer de Camins, C. i P. ganyet@ramon.com 25700 LA SEU D'URGELL	EL INGENIERO: RAMON GANYET SOLÉ	NOTA: 	REVISED: Elevades	ESCALA: 1:1000	FECHA: JULIO 2014	PROYECTO: INFRAESTRUCTURAS DEL PARQUE OLÍMPIC	PLANO: PLANO DE EMERGENCIA Y EVACUACION	BLANQUEO: 3
--	--	---	------------------------------------	-----------	----------------------	-------------------	----------------------	--	--	----------------



### **ORGANIZING COMMITTEE:**

Sr. D. Juan José Román Mangas  
RFEP President and Organizing Committee Chairman

Sra. D<sup>a</sup> Ana Muñoz Merino  
Sports Director of Spanish Sports Council

Sr.D. Ivan Tibau Ragolta  
Secretary General of Sports of Generalitat de Catalunya

Sr. D. Albert Batalla Siscart  
Mayor of La Seu d'Urgell

Sr. D. Joan Reñé Huguet  
President of Lleida provincial Council

Sr. D. Joan Ignasi Rosell Urrutia  
President of Catalan Canoe Federation

Sr. D. Jean Michel Prono  
Chairman of ICF Canoe Slalom Committee

Sr. D. Ramon Ganyet Solé  
Manager Director of Organizing Committee

Sr. D. Enric Balastegui Artigues  
Presidente of CADí Canoe Kayak club

Sra. D<sup>a</sup>. Núria Vilarrubla Cortina  
Secretary General of Organizing Committee

Sr. D. Francesc Ganyet Solé  
Manager of Parc Olímpic del Segre



## Provisional competition programme



28 to 31 July	Official training
July, 30 <sup>th</sup>	Team leaders meeting
July, 31 <sup>st</sup>	Demonstration run Officials meeting Opening ceremony
August 1 <sup>st</sup> Friday	Heats – two runs: C-1 M, C-1 W and K-1 M Heats – two runs: K-1 W and C2 M
August 2 <sup>nd</sup> Saturday	Semifinal & final C-1M, C-1 W and K-1 M Medals ceremony
August 3 <sup>rd</sup> Sunday	Semifinal & final K-1 W and C2M Medals Ceremony

## Entries and Important dates to remember for Team Leaders



### Numerical entries:

You will find a numerical entry form in <http://canoeslalomseu.parcolimpic.cat>

Deadline for reception: **16<sup>th</sup> of June**

### Nominal entry:

Entries will be done on the form designed and provided by the ICF, which will be available on-line on: ICF integrated sport information system (ISIS) <https://isis.msl.es/icf/main.jsp> before **16<sup>th</sup> of July**  
For further information relating to the ISIS process: <http://canoeicf.com/icf/Misc/ISIS.html>

All entries sent after 16<sup>th</sup> July will have to be accepted by the Chairman of the ICF Canoe Slalom Committee (ICF rules - art. 11.2)

### Information number boats x nation:

[http://www.canoeicf.com/icf/Aboutoursport/Canoe-Slalom/Race-Information/2014-Race-Information/main/00/text\\_files/file2/2014%20ICF%20CSL%20World%20Cup%20Quota%20Information.pdf](http://www.canoeicf.com/icf/Aboutoursport/Canoe-Slalom/Race-Information/2014-Race-Information/main/00/text_files/file2/2014%20ICF%20CSL%20World%20Cup%20Quota%20Information.pdf)

### KEY DATES:

<b>June 16<sup>th</sup></b>	Last day for numerical entries by our web
<b>July 16<sup>th</sup></b>	<b>Last day for nominal entries by ICF on line system</b>
<b>July 21<sup>st</sup></b>	<b>Last day for accreditation by ICF on line system</b>
July 28 <sup>th</sup>	Opening free official period training
July 30 <sup>th</sup>	Team Leaders Meeting
July 31 <sup>st</sup>	Opening Ceremony



## Accreditation and participation fee

### ICF ON-LINE ACCREDITATION SYSTEM: <https://isis.msl.es/icf/main.jsp>

This system will allow National Federation delegation members and Officials to register online and get the accreditation at their arrival on site.

If you are in need of a User ID and Password or have a suggestion or a problem, please contact Michael Noyelle to: [isis@canoeicf.com](mailto:isis@canoeicf.com)

### PARTICIPATION FEE FOR ALL THE MEMBERS OF THE TEAMS:

Price of each accreditation for all days: **105 Euros**

It Includes:

- Training in the course during official period
- Automatic Chrono and video service in the competition days
- Drinks and fruits in the competition days
- Lunch in the closing party

### NATIONAL FEDERATION (NF) categories: 21<sup>st</sup> July dead line for reception

Qualification	Symbol	Remarks	Cost
Athletes	Aa	Limited to registered athletes on ICF online entries	105 €
Team Leader	Ac	2 accreditations max. per nation	105 €
Technical staff	Ao	-	105 €
Medical Staff	Am	-	105 €
National Federations guests	NF-VIP*	Gives access to the VIP area	105 €
President or Secretary General of NF	NF-VIP	2 per nation To be validated by ICF	Free
International Officials	ICF ITO	According to the list edited by the ICF	Free

### HOW TO PAY PARTICIPATION FEE?

The payment can be made by bank transfer or on site at your arrival at La Seu d'Urgell.

Bank Transfer needed details:

**IBAN: ES49 2100 3603 7022 0026 1988**

**SWIFT Code: CAIXESBBXXX**



# La Seu d'Urgell

## Turisme de La Seu

### **ACCOMMODATION**

Please, see this web site <http://www.turismeseu.com>, where you can find all the options (hotels, rural accommodations, etc...)

For more information or booking you can call Tel. (34) 973 35 15 11 or send an e-mail: [reserves@turismeseu.com](mailto:reserves@turismeseu.com)

### **PRESS AND MEDIA INFORMATION**

Information will be available at <http://canoelalomseu.parcolimpic.cat> in the section "Press"

There will be live coverage by TVE for all competition: heats, semi-final and final

### **BOAT STORAGE**

Boat storage will be placed near flat water in Parc Olímpic del Segre

### **INTERNET ACCESS**

Free wireless internet access will be available at Parc Olímpic del Segre

### **ACCESS PARC AND PARKING**

Free access pass and car parking near Parc Olímpic del Segre will be guaranteed.



## Information from the organizer

### VISA

The Royal Spanish Federation of Canoeing is pleased to inform:

If you need a visa, please as soon as possible contact by e-mail: [correo@rfep.es](mailto:correo@rfep.es)

### TRANSPORTATION

The Organizing committee will provide with transportation from and to Barcelona airport for all members of the ICF Jury.

Also Organizing Committee can organize transportation from and to Barcelona airport for the teams, their members and all ICF officials.

If you are interested, please as soon as possible contact by e-mail: [canoeslalomseu@parcolimpic.cat](mailto:canoeslalomseu@parcolimpic.cat)

### MEDICAL SERVICES IN LA SEU D'URGELL

The health care services of the Sant Hospital Foundation will be available for canoeists and accompanying personnel.

This Hospital has beds, orthopaedic and surgical departments and emergency services including treatment at accommodation.

The official training days and competitions days (according to the programme) in Parc Olímpic del Segre will be covered by first aid and ambulance service for transportation to hospital if necessary.

### WEATHER IN LA SEU D'URGELL

The weather is gentle and the climate is Mediterranean.

In July/August, the temperatures are warm at day and cool at night with sunny days. The average daily temperature is 20° C, and average rainfall is 67mm/month.

During the competition hours, the maximum temperature is around 25 °C





**CONTACTS:**

**Real Federación Española de Piragüismo** <http://www.rfep.es>  
c/ Antracita, 7 -3º  
28045 MADRID  
Tel (34) 911123805  
E-mail: [correo@rfep.es](mailto:correo@rfep.es)

**Parc Olímpic del Segre** <http://canoeslalomseu.parcolimpic.cat>  
25700 La Seu d'Urgell (Lleida)  
Tel. 34 973 36 00 92  
Fax. 34 973 36 01 92  
E-mail: [canoeslalomseu@parcolimpic.cat](mailto:canoeslalomseu@parcolimpic.cat)

**Internacional Canoe Federation** <http://www.canoeicf.com>

**La Seu d'Urgell Tourist information** <http://www.turismeseu.com>

**La Seu d'Urgell Town hall** <http://www.laseu.cat>

**Catalan Canoeing Federation** <http://www.fcpiraguisme.com>



**Parc Olímpic del Segre** - 25700 La Seu d'Urgell (Lleida) Tel. (34) 973 36 00 92 Fax. (34) 973 36 01 92  
<http://canoeslalomseu.parcolimpic.cat> - E-mail: [canoeslalomseu@parcolimpic.cat](mailto:canoeslalomseu@parcolimpic.cat)

**Real Federación Española de Piragüismo** - c/ Antracita, 7 -3º - 28045 MADRID  
Tel. (34) 911123805 - <http://www.rfep.es> - E-mail: [correo@rfep.es](mailto:correo@rfep.es)